

HHA-A-4KUHD

4K UHD HDR 18Gbps HDMI Audio Extractor

Our 4K HDMI audio extractor is designed for home and professional audio systems, a pass-through device that converts digital surround sound or 2-channel (PCM) to L/R analog stereo out. A perfect solution that will connect a HDMI output only source such as a newer Blu-ray player to a second zone or house multi-zone amplifier. This allows HDMI equipment with the latest technology (i.e. displays, audio receivers or matrix switchers) to be more backwards compatible with older analog equipment. Not only does this HDMI to analog converter improve sound quality, it auto-detects and auto-converts the audio signal, making sound come alive and more realistic.

Features:

- > Supports high bandwidth pass-through up to 4Kx2K@60Hz
- > UHD HDR 4:4:4 18Gbps
- > 10 bit HDR (High Dynamic Range) pass through
- > Optical audio supports LPCM 2CH, Dolby Digital 2/5.1CH, DTS 2/5.1CH
- > Supports HDMI High Bit Rate (HBR) audio pass through
- > Optical Audio sample rates up to 192kHz
- > Supports CEC bypass
- > Easily connects to earphones or an audio amplifier
- > Plug n Play, Small form factor

Package Includes:

- Audio Extractor x 1
- 5V 1A Power Supply x 1
- Instructions x 1

Connections and Functions:

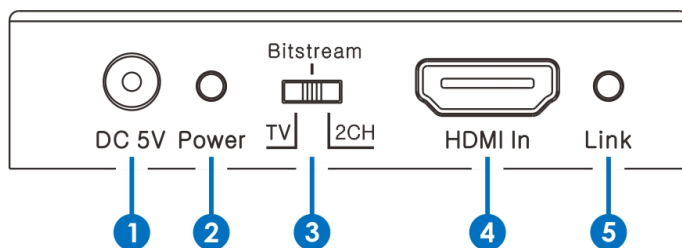

- 1 DC 5V:** Connect 5V/1A adaptor to AC wall outlet for power supply.
- 2 Power LED:** System power indicator.
- 3 TV / Bit Stream / 2CH:** This allows users to select audio format according to TV, Bit Stream or LPCM 2CH. (TV mode means EDID will copy from TV and will support all audio formats TV can support. Bit Stream is Dolby/DTS 5.1. LPCM is normal stereo audio.
- 4 HDMI In:** Connect this to HDMI source devices such as Blu-ray or PS4 player
- 5 Link LED:** The LED will illuminate when HDMI input signal detected.

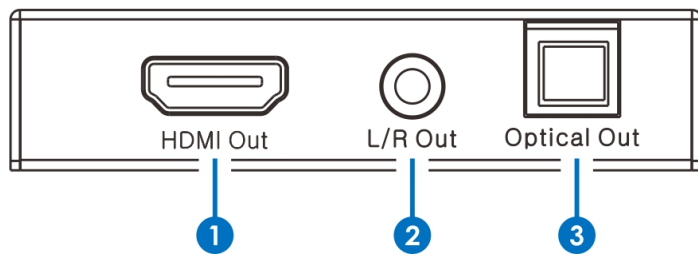

- 1 HDMI Out:** Connect to HDMI display devices such as TV/Projector.
- 2 L/R Out:** Connect to audio amplifier or TV L/R audio input port.
- 3 Optical Out:** Connect to audio amplifier optical audio input port.

NOTE: If audio is PCM2.0 then both the optical digital port and the Analog L/R port are active at the same time; if audio is Dolby or DTS then there will be optical digital port with audio ONLY.

Application:

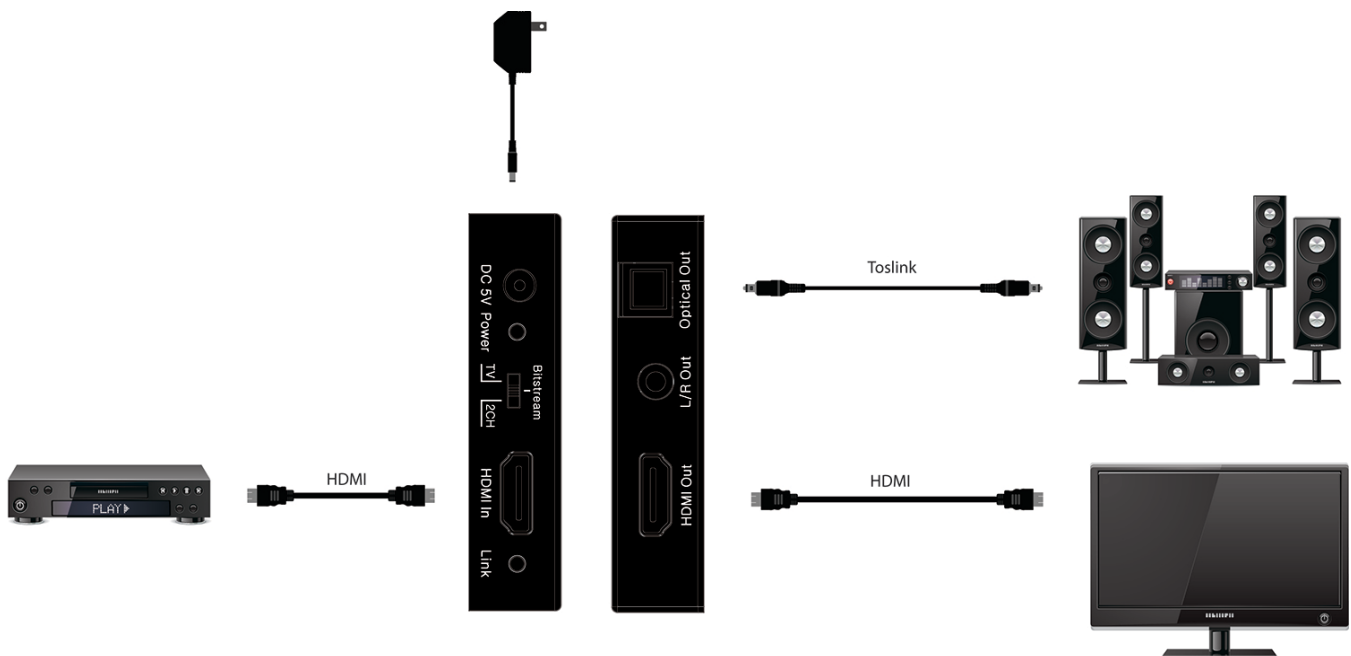

Specification:

Technical	
HDMI Compliance	HDMI 2.0b
HDCP Compliance	HDCP 2.2 and HDCP 1.4
Video Bandwidth	18 Gbps
Video Resolutions	up to 4K2K@50/60Hz(YUV4:4:4),4K2K@30Hz,1080P@120Hz, and 1080P 3D@60Hz
Color Space	RGB, YCbCr 4:4:4, YCbCr 4:2:2
Color Depth	10-bit, 12-bit
HDMI Audio Formats (Pass-through)	LPCM 2/5.1/7.1CH, Dolby Digital, DTS 5.1, Dolby Digital+, Dolby TrueHD, DTS-HD Master Audio, Dolby Atmos, DTS:X
Optical Audio Formats	LPCM 2CH, LPCM 5.1, Dolby Digital 2/5.1CH, DTS 2/5.1CH
L/R Audio Formats	Analog Stereo 2CH
ESD Protection	Human body model — ±8kV (air-gap discharge) & ±4kV (contact discharge)
Connections	
Inputs	1x HDMI Type A (19-pin female)
Outputs	1x HDMI Type A (19-pin female) 1x L/R Audio Out (3.5mm Stereo Mini-jack) 1x Optical Out (S/PDIF)
Mechanical	
Housing	Metal Enclosure
Color	Black
Dimensions	2.89" (W) x 2.39" (D) x .67" (H)
Weight - lbs.	.28
Power Supply	Input: AC100 - 240V 50/60Hz Output: DC 5V/1A (US/EU standards, CE/FCC/UL certified)
Power Consumption	1W (Max)
Operation Temperature	32 - 104°F / 0 - 40°C
Storage Temperature	-4 - 140°F / -20 - 60°C
Relative Humidity	20 - 90% RH (no condensation)

Do you Need Technical Support?

ZUUM is proud to offer free technical support to ensure your product is operating correctly. If you are experiencing difficulties setting up this product, please call us for assistance 1-888-861-7351 or visit www.zuum.life
Here for You 24/7